



Oneidas bringing several hundred bags of corn to Washington's starving army at Valley Forge, after the colonists had consistently refused to aid them.

Oneida Tribe of Indians of Wisconsin

Phone: 869-2771



Oneida, WI 54155



UGWA DENOLUH YATEHE
Because of the help of this Oneida Chief in cementing a friendship between the six nations and the Colony of Pennsylvania, a new nation, the United States was made possible.

RESOLUTION NO. 2-22-85-B

- WHEREAS, The governing body of the Oneida Tribe of Indians of Wisconsin is the Oneida General Tribal Council, and
- WHEREAS, the Oneida General Tribal Council has delegated its governing powers and responsibilities to the Oneida Business Committee, subject to its review, and
- WHEREAS, the legal right of Oneida Indians to hunt and fish on the Oneida Indian Reservation is defined by the 1838 Treaty, and
- WHEREAS, it has been determined that the treaty protected rights to hunt and fish on the Oneida Reservation by Oneida Indians can best be accomplished by the establishment of an Oneida Conservation Board, and
- WHEREAS, it has been determined that the establishment of the Oneida Conservation Board will benefit the Oneida Tribe, from the present into the future, by overseeing and coordinating all tribal conservation activities including, reforestation, recreational development and the orderly regulation of hunting and fishing on the Oneida Indian Reservation.

NOW, THEREFORE BE IT RESOLVED: That the Oneida Conservation Board is hereby established to carry out the purposes set forth above, and

BE IT FURTHER RESOLVED: That the attached charter and by-laws shall govern the conduct and activities of the Oneida Conservation Board.

BE IT FINALLY RESOLVED: That the following named persons are hereby appointed as the first Oneida Conservation Board members:

- | | |
|-------------------|----------------------|
| 1. Larry Barton | 5. Jerry Kurowski |
| 2. Bob Christjohn | 6. Al Manders |
| 3. Ted Hawk | 7. Dennis G. Powless |
| 4. Harlan King | |

The following persons are hereby appointed as alternates to the first Oneida Conservation Board members, and may serve in the absence of any of the regular members.

1. Jim Danforth
2. Bill Sauer
3. Gary Ness

All persons will be installed by public oath at a regular meeting of the Oneida Business Committee by the Chairman or his delegate prior to commencing business.

The first Oneida Conservation Board will serve until the first annual meeting when they may be succeeded or re-elected as determined by, and provided for the Charter and By-laws.

C E R T I F I C A T I O N

I, the undersigned, as Secretary of the Oneida Business Committee, hereby certify that the Oneida Business Committee is composed of nine (9) members of whom 7 members, constituting a quorum, were present at a meeting duly called, noticed, and held on the 22 day of February, 1985; that the foregoing resolution was duly adopted at such meeting by a vote of 6 members for, 0 members against, and 0 members abstaining: And that said resolution has not been rescinded or amended in any way.

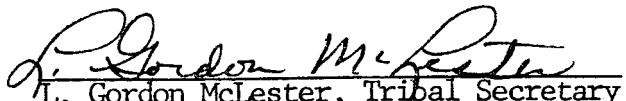
L. Gordon McLester, Tribal Secretary
Oneida Business Committee

1000.20'

Lot 3
Sec. 6
30.00 Ac. ±

Lot 5
Sec. 6
26.00 Ac.

1329.8'

33'

200.9'

1327.1'

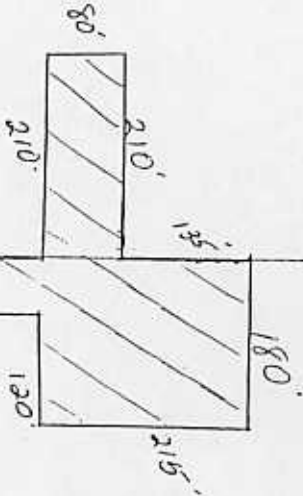

ONEIDA AIRPORT LANDS

A commercial and industrial area located in Lot 5, Section 6, Township 23 North, Range 20 East, 4th Principal Meridian, Wisconsin (Brown County), containing 26 acres, more or less; and Lot 3 Section 6, Township 23 North, Range 20 East, 4th Principal Meridian, Wisconsin (Brown County), containing 30 acres, more or less, except therefrom the South 2 rods.

Owner: Oneida Trish

AIRPORT
ENTRANCE

AIRPORT DR. (COUNTRY)

A right of way easement for sewer and water services described as follows:

Beginning at the southeast corner of government lot 5, thence continuing N0°-20'-38" W 185 feet, thence S89°-37'-24" W 210 feet, thence N0°-20'-39" W 80 feet, thence N89°-37"-24" E 210 feet, thence N0°-20'-38" W 135 feet, thence N89°-37'-24" E 180 feet, thence S0°-20'-38" E 215 feet, thence S89°-37'-24" W 120 feet, thence S0°-20'-38" E 185 feet, thence S89°-37'-24" W 60 feet to the point of beginning.